



Contact us

Customer Support

To reach customer support for individual subscribers or users at an institution, please contact:

Online

www.wolterskluwer.com/en/solutions/lexicomp/contact-us

Phone

1.800.998.6374 or +1.781.392.2000

Monday through Friday, 7a.m. – 9p.m. (Eastern time)

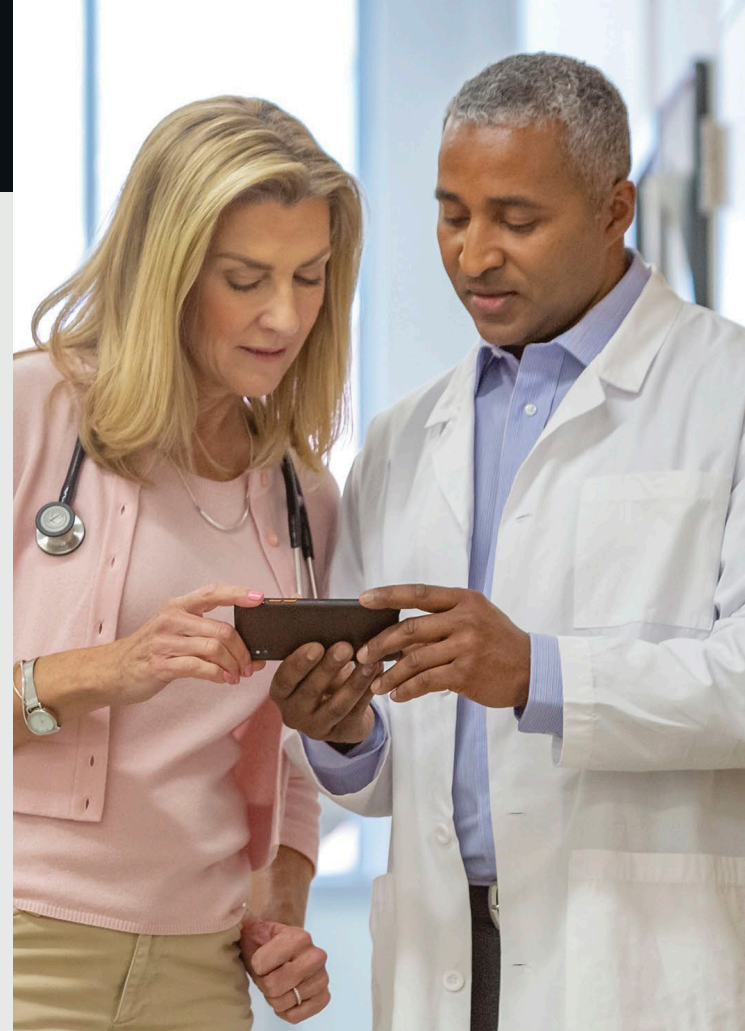

Find your drug answers faster with Lexicomp

Searching in Lexicomp

With Formulink*, review your organization's formulary policy on the specific drug.

Lexicomp contains a number of content sets which are structured to help you quickly locate what you need. Click a drug monograph hyperlink under a content set name to access further information.

The Lexi-Drugs® core drug information database contains information structured for use at the point of care. If you're seeking deeper information, you have the ability to jump right to a monograph within one of our more in-depth content sets.

To find information in Lexicomp, type keywords in the search box located on the homepage or on the top left corner of every page. Keyword searches can include drug names, lab tests, calculators, or diseases.

When you begin typing your search keywords, suggested terms will appear when at least two characters are entered.

Advanced search allows you to search using keywords within content sets or within a specified field. Access Advanced Search under "More Clinical Tools."

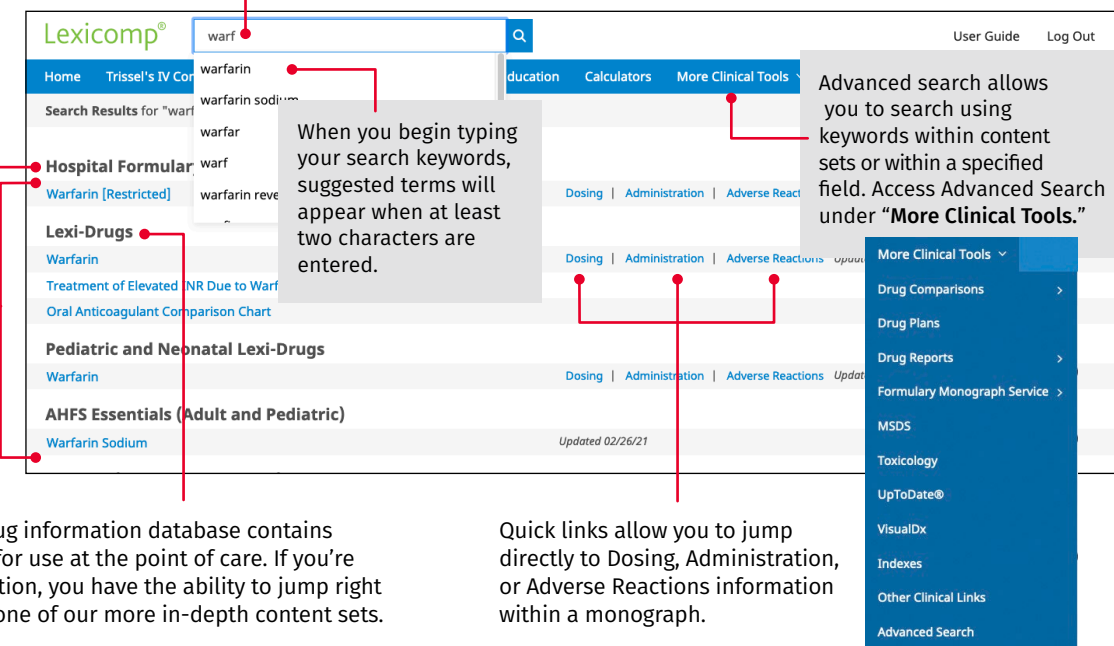

Quick links allow you to jump directly to Dosing, Administration, or Adverse Reactions information within a monograph.

Navigating content within a drug monograph

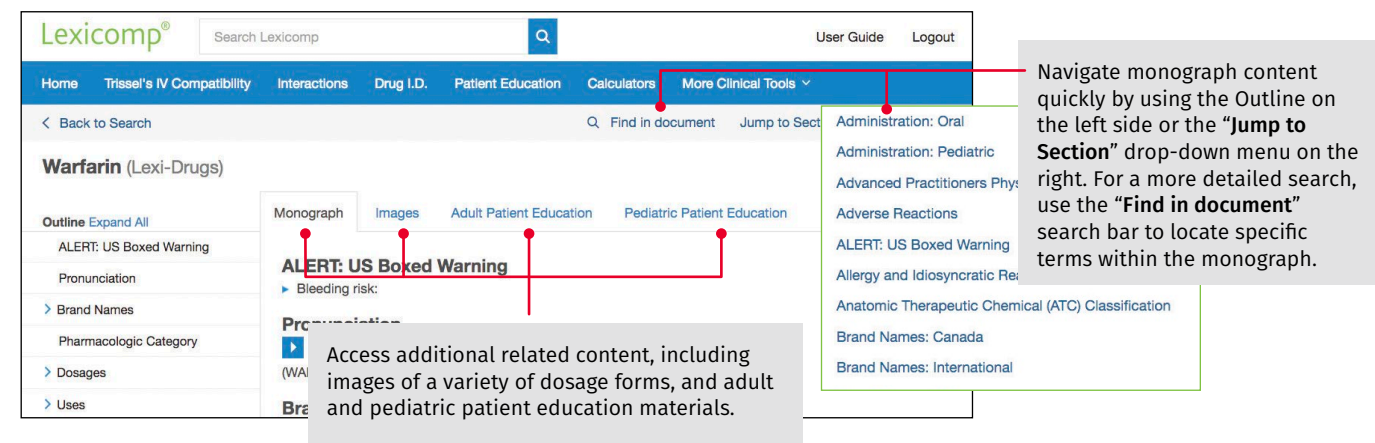

Navigate monograph content quickly by using the Outline on the left side or the "Jump to Section" drop-down menu on the right. For a more detailed search, use the "Find in document" search bar to locate specific terms within the monograph.

Access additional related content, including images of a variety of dosage forms, and adult and pediatric patient education materials.

Lexicomp® Quick Reference Guide

Supporting smart, safe drug decision making at the point of care



www.wolterskluwer.com

©2012-2023 UpToDate, Inc. and its affiliates and/or licensors. All rights reserved. 01.23 | 12512



*Formulink formulary management solution can be added to a Lexicomp organizational license for a fee.



Using the clinical decision tool bar

The blue clinical decision tool bar provides access to all clinical tools included in your subscription. Click on “More Clinical Tools” to access additional features available in Lexicomp.

Drug ID

Drug ID assists in the identification of tablets, capsules, and various other dosage forms. Narrow your search results by including as many details as possible, including:

- Imprints
- Shape
- Dosage form
- Color

Patient Education

The Patient Education module allows you to search for and print condition/procedure or medication patient-facing leaflets (available in up to 20 languages). You can create packets of leaflets as an individual user or across your organization for simple access to materials used in common clinical scenarios.

Calculators

Lexicomp includes more than 100 medical calculators. Locate the desired calculator within the tool using the “search box” or “browse category” functions.

IV Compatibility

Access stability and compatibility information using data incorporated from Trissel’s 2nd Clinical Pharmaceutics Database by Lawrence A. Trissel. You can enter any number of drugs or solutions to create a compatibility chart. By clicking on the drug name under “selected items,” you can view all compatibility results for a single drug.

Interactions

The Interactions tool includes drug, allergy, and herbal interactions, helping you screen a summary of interactions for multiple:

- Prescription or over-the-counter medications
- Natural products
- Foods/alcohol
- Drug allergies

You can click on “Interactions” to view additional details and to see management and supporting references.

More Clinical Tools

- **Drug Comparisons** ^A
Drug Comparisons provides you with the ability to compare up to four drugs across classes to determine or evaluate therapies. It offers two views of information:
 - Data View allows you to create custom data tables
 - Monograph View displays side-by-side comparisons
- **Toxicology** ^B
To search the Toxicology database, enter a drug or product and click “search.”

Lexicomp also includes more than 1,200 material safety data sheets (MSDS) ^C, which are accessible by clicking on “More Clinical Tools” on the blue tool bar.
- **Indexes** ^D
Review descriptions of all available content sets within your Lexicomp subscription. The indexes section allows you to quickly link to more information, including available fields and the list of editorial advisory panel members.
- **Other Clinical Links** ^E
Easily link to external websites for additional clinical information or research, including the National Library of Medicine, ASHP (Drug Shortages), FDA (Recalls, Withdrawals, and Safety Alerts), and more.
- **Advanced Search** ^F
See details on previous page.